

# 1

# Introduction

Moire Park playground and paths are being upgraded and this is your opportunity to have your say on the proposed design, and choose your preference for the play tower.

In May 2019, we asked what play experiences and activities you would like at Moire Park. We have used your feedback to inform the development of this Concept Plan

The information provided in this document outlines the project background, the proposed playground designs with two options for the play tower and the proposed path layout.

To provide feedback on the Concept Plan and your preferred tower visit:  
[aucklandcouncil.govt.nz/haveyoursay](http://aucklandcouncil.govt.nz/haveyoursay)

## Site context

Moire Park is a significant open space, occupying some 33 hectares of coastal land at the western end of the Waitematā Harbour. The park sits at the confluence of the Manutewhau Creek (to the north) and Te Wai-o-Pareira / Henderson Creek to the east, at the point where they join the Waitematā Harbour.

Moire park is a well used park, home to Massey Athletics Club and Massey Rugby Football Club. It has a number of walkways that connect to the surrounding community. Moire Park playground is located on the parks southern boundary, adjacent to Granville Drive. Moire Park playground is the largest playground, offering the greatest number of play activities in this area.

The current playground is reaching the end of its lifespan, and is due to be renewed. The western boundary of Moire Park is a Special Housing Area, currently under development which is generating a need for an improved playground.

## Indicative project timeline

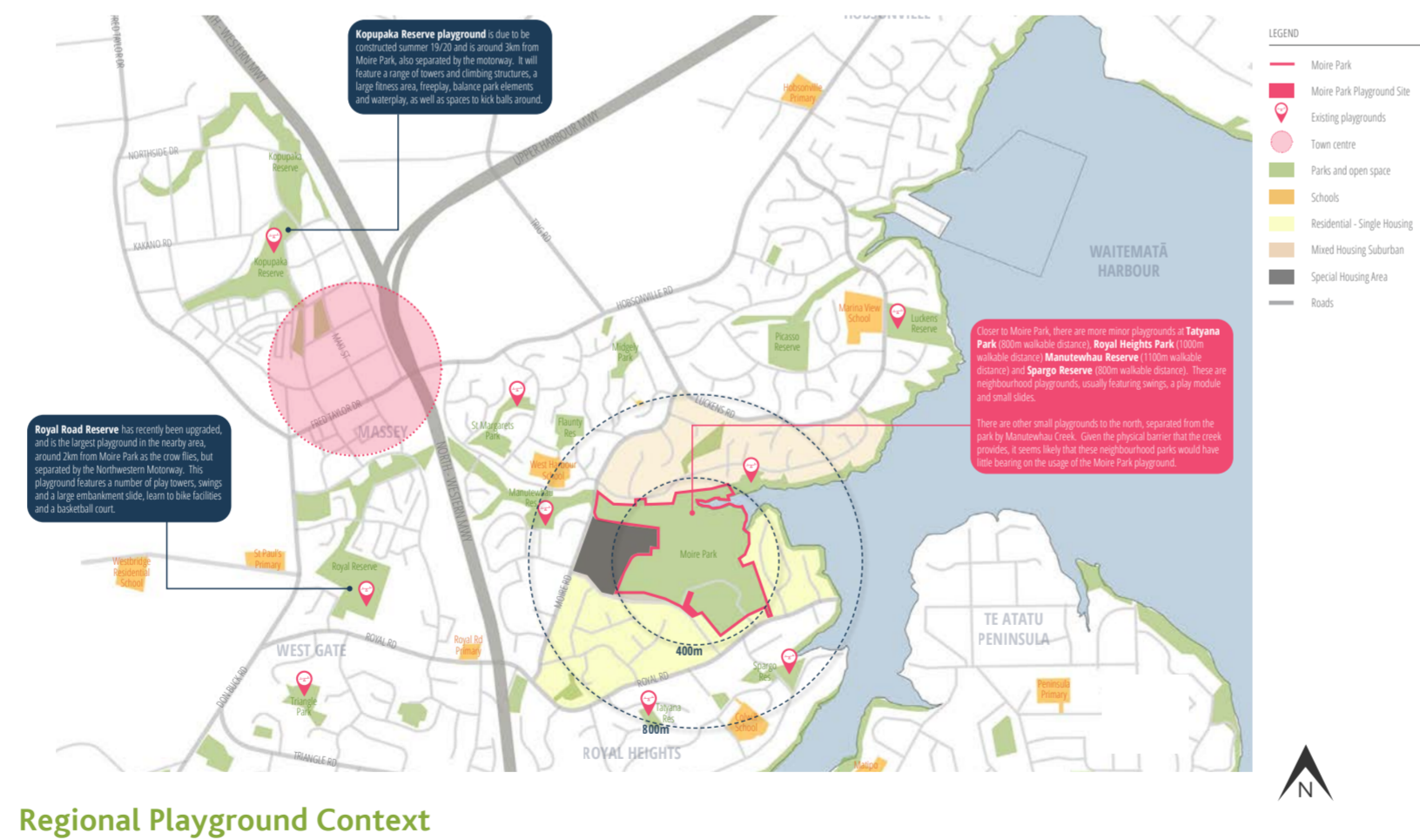
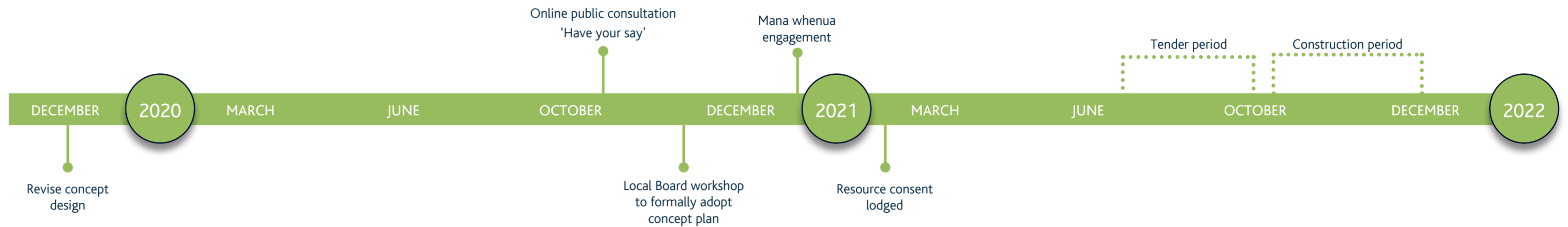

Find out more:  
[visit aucklandcouncil.govt.nz/haveyoursay](http://visit.aucklandcouncil.govt.nz/haveyoursay)  
 or call 09 301 0101



# 2

# Concept Plan

## What we heard

In May 2019, public consultation was carried out on Moire Park Playground to learn what you liked about the existing park, and what play experiences/activities you wanted included in the playground development. A range of feedback was gained through this process and a summary of the results are as follows and in the adjacent images.

Popular items with older children included; full-size basketball court, lying fox, obstacle courses, climbing and sliding and a bmx track.

Popular items with younger children included; Climbing/sliding/jumping/spinning, water play, a 'learn to ride' bike track, balancing, and walking paths

Non-playground equipment related suggestions included; ball sports (football and tennis), bike/scooter tracks paths for younger children, walking paths to connect to existing bush tracks and sheltered areas with seating and picnic tables.

### Play activities you like to see at Moire Park included:



Climbing



Sliding



Swinging



Spinning



Learn to ride



Water play

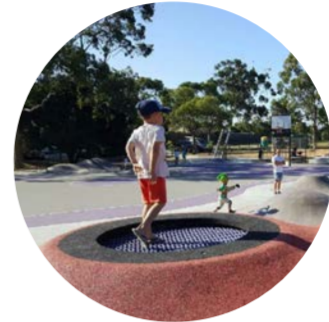

Jumping



Sand play



Balancing

## Design development

The following diagram outlines the design intent of the proposed playground, that has been developed in partnership with Mana whenua. The plan outlines the concept developed for the playground.

The intent going forward is that we work with mana whenua to unlock and uncover local narratives, and these may be reflected in artistic ways as art pieces worked into posts, the ground plane or as free-standing elements. We aim to unearth, discover, explore and investigate (Tūhura) through design to showcase the historic elements of Pareira and kai gathering in various play zones. The objective is to transform Moire Park as a place of discovery (He Wahi Tūhura) to the locals and visitors via improvements towards walking tracks/trails and Manutewhau.

There is a underpinning philosophy to the design of adaptive reuse - we took a standpoint of keeping what we can and working with this, rather than starting with a clean slate. This has been applied in the central module area, where we plan to reuse a number of existing structural posts in the nature play area. The concrete path surrounding this space will also be retained, and rough-honed to bring up to a higher amenity finish. Other sections of path to be removed will be reused as crazy paving around the swing set and nature play area.

All the play activities will be zoned accordingly to cater for children of different age groups, which will include; sand play, inclusive play, balancing/confidence course within nature play, puzzles and climbing.



*Te Wāhi Tūhura  
A place of Discovery*



### NOTES

- 1 Minor drainage improvements to existing BMX track. Potential community-led project to improve surfacing as part of a future stage of works
- 2 Proposed full-size asphalt basketball court, allowing either half or full court games to be played
- 3 Break out seating space for basketball area
- 4 Double swing set with basket. Vegetated buffer to basketball area, and crazy paving link to flying fox
- 5 Grassed picnic area under existing trees
- 6 Off the shelf shade structure, with picnic tables/bbq underneath. Investigate potential to relocate existing bbq in this area
- 7 Timber play module based on potential reuse of the existing posts, but with new decking and climbing/sliding elements added. Small tower to centre, set amongst low planting and specimen trees
- 8 Low planting buffer and edging to between learn to ride bike track and playspace
- 9 Proposed bark area with play opportunities that demonstrate kai gathering, set amongst main tower and climbing structures
- 10 Existing circular path retained and rough-honed
- 11 Balance ball / slackline area
- 12 In ground trampolines, set as a pair to allow jumping/tricks between
- 13 Nature play area that reflects Tūhura, through different play elements set amongst native planting/mounding and trees to narrate the history of the site. Reuse existing timber posts from existing module
- 14 Sand pit with timber log edging, set within nature play area
- 15 Area to be vegetated with low growing, dense vegetation to act as a barrier between playspace and carpark/Granville Drive
- 16 Proposed connecting paths - note most existing paths have been retained and incorporated into the design
- 17 Existing path to toilet facility
- 18 Crossing point on road - painted road markings recommended due to budget
- 19 Existing drinking fountain retained
- 20 Proposed litter bins
- 21 Low concrete wall with entry signage and opportunity to work with mana whenua and children for creative artwork



Find out more:  
visit [aucklandcouncil.govt.nz/haveyoursay](http://aucklandcouncil.govt.nz/haveyoursay)  
or call 09 301 0101

# 3

## Play equipment

Tower option one

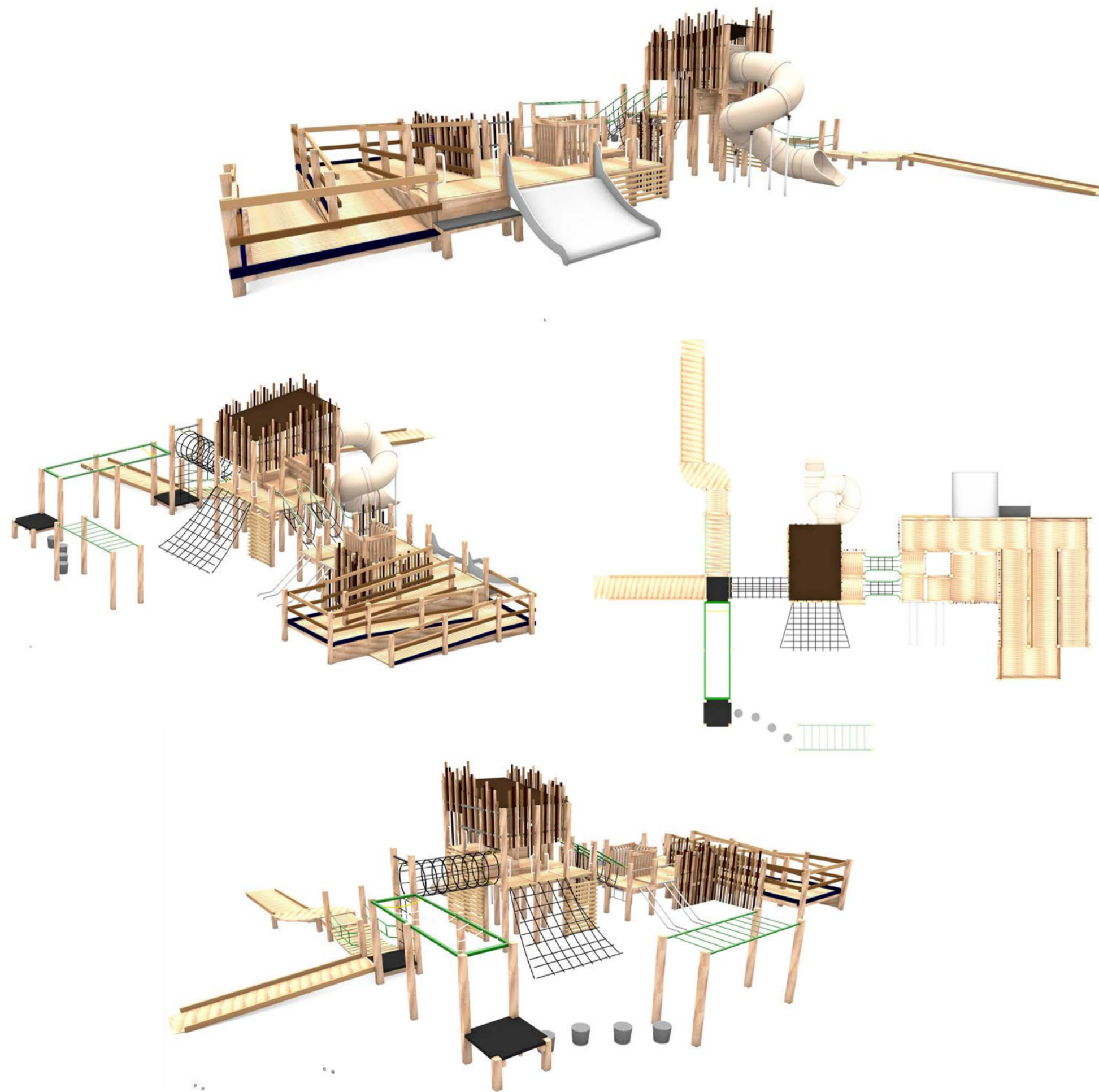

Tower option two

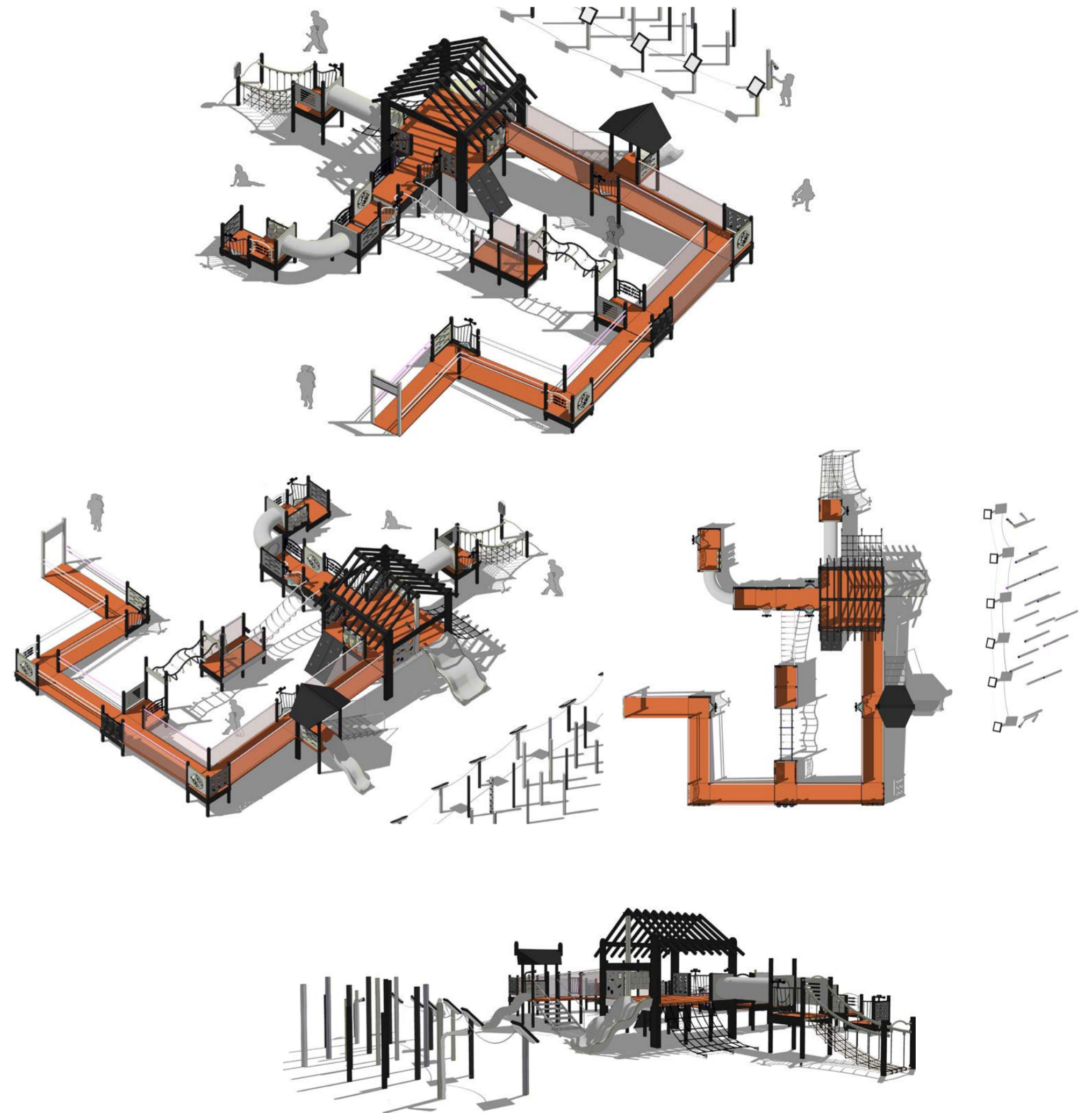

Have your say

Find out more:  
visit [aucklandcouncil.govt.nz/haveyoursay](http://aucklandcouncil.govt.nz/haveyoursay)  
or call 09 301 0101

# 4

# Precedent Imagery



Find out more:  
visit [aucklandcouncil.govt.nz/haveyoursay](http://aucklandcouncil.govt.nz/haveyoursay)  
or call 09 301 0101

# 5

# Moire Park - Path Connections

A proposal has been developed to increase path connections from Moire Park to the new residential development. This will improve accessibility and provide additional walking routes within the park.

A 2m wide concrete path is proposed circumnavigating the existing rugby / athletics field. A compacted gravel path is proposed through the existing bush area and a boardwalk across an overland flowpath. Concrete steps are proposed to connect in to the new residential development.

This is your opportunity to have your say on the proposed path connections.

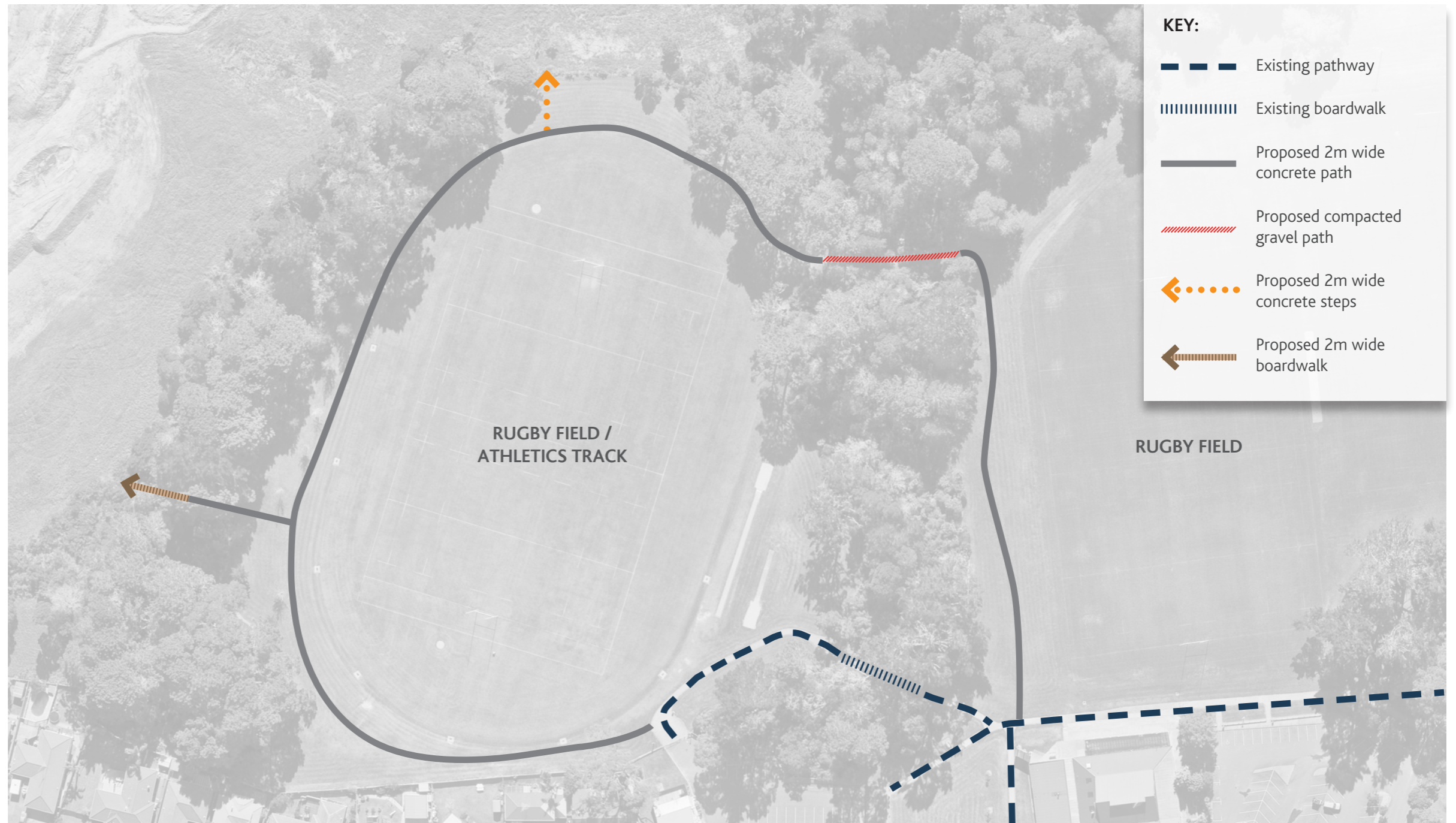

Have your say

Find out more:  
visit [aucklandcouncil.govt.nz/haveyoursay](http://aucklandcouncil.govt.nz/haveyoursay)  
or call 09 301 0101